

Accessories

COMPLEMENTARY PRODUCTS

**CLH-1S
CLH-1SX**

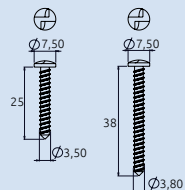

CLH-1MF

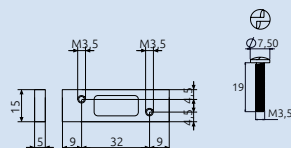

CLH-1D

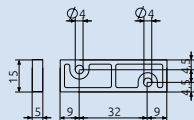

CLH-2MF

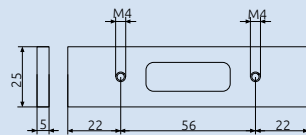

CLH-2XT



MAG-AL



CLS-1D



**CLH-2G10
CLH-2G5**



CST-0MF

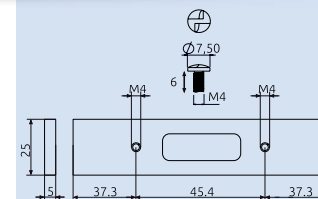

CST-1MF

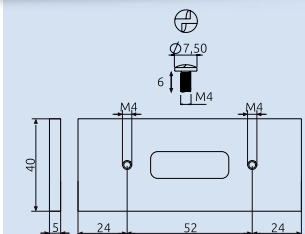

Accessories

COMPLEMENTARY PRODUCTS

HPA-200



SC-FLAT-1.5MM



Ordering guide

PART No.	DESCRIPTION	PACKAGING
CLH-1S	Anti-tamper one way screws, self-tapping, round head, stainless steel, 25x3,5mm - 16 pcs. pack for the installation of 4 contacts (S, H, CST or CLV series)	16 pcs. per package
CLH-1SX	Anti-tamper one way screws, self-tapping, round head, stainless steel, 38x3,8mm - 16 pcs. pack for the installation of 4 contacts (S, H, CST or CLV series)	16 pcs. per package
CLH-1MF	Iron support, 15x50x5mm with M3.5 threaded M3.5 - 8 pcs. pack with 16 anti-tamper stainless steel screws for the installation of 4 CLH-1xx contacts	8 pcs. per package
CLH-1D	5mm ABS spacers - 8 pcs. pack for the installation of 4 CLH-1xx contacts	8 pcs. per package
CLH-2MF	Iron support, 25x100x5mm with M4 threaded holes - 2 pcs. pack with 4 anti-tamper stainless steel screws for the installation of 1 CLH-2xx contact	2 pcs. per package
CLH-2XT	Supplementary neodymium magnet for installations with larger operating gap, artt. CLH-2xx	1 magnet
MAG-AL	Neodymium magnet - 40x14x5 mm - 10 pcs. pack	10 pcs. per package
CLS-1D	5mm transparent plexiglass spacers - 10 pcs. pack for the installation of CLS contacts	10 pcs. per package
CLH-2G10	Stainless steel armoured sheath, d.ext. 7mm, d.int.5mm for CLH-2xx, CLV-02, CLV-03, CST-0xx and CST-1xx products	10m cuts
CLH-2G5		5m cuts
CST-0MF	Iron support, 25x120x5mm with M4 threaded holes - 2 pcs. pack with 4 anti-tamper stainless steel screws for the installation of 1 CST-0xx contact	2 pcs. per package
CST-1MF	Iron support, 40x100x5mm with M4 threaded holes - 2 pcs. pack with 4 anti-tamper stainless steel screws for the installation of 1 CST-1xx contact	2 pcs. per package
HPA-200	Electrolube HPA spray, protective acrylic laquer for screw terminals, professional use	1 200ml can
SC-FLAT-1.5MM	Flat 1.5mm precision screwdriver	1 pcs. per package